

THIS DRAWING IS THE PROPERTY OF PIERCE MANUFACTURING. IT IS CONFIDENTIAL AND ALL RIGHTS ARE RESERVED. IT SHALL NOT BE REPRODUCED, COPIED, LENT, OR USED FOR ANY PURPOSE OTHER THAN THAT FOR WHICH IT IS SPECIFICALLY FURNISHED.

BID # 000  
REP: Steve Williamson - Frontline Communications  
DEALER: Halt Fire

PRELIMINARY USE ONLY  
THIS DRAWING IS FOR REPRESENTATION ONLY. DETAILED ENGINEERING DRAWINGS WILL BE CREATED FOR MANUFACTURING. CHANGES MAY BE REQUIRED TO ACCOMMODATE MANUFACTURING REQUIREMENTS AND CUSTOMER SPECIFICATIONS.

**FRONTLINE**  
COMMUNICATIONS  
An Oshkosh Corporation Company

DRAWN	JRP	DATE	01/28/25
SHEET	1 OF 6	NOT TO SCALE	

Eaton County Sheriff  
Mobile Command Unit  
C-37 X-2 - M2-106

SIZE	DWG NO.	REV
B	P2023-108	A

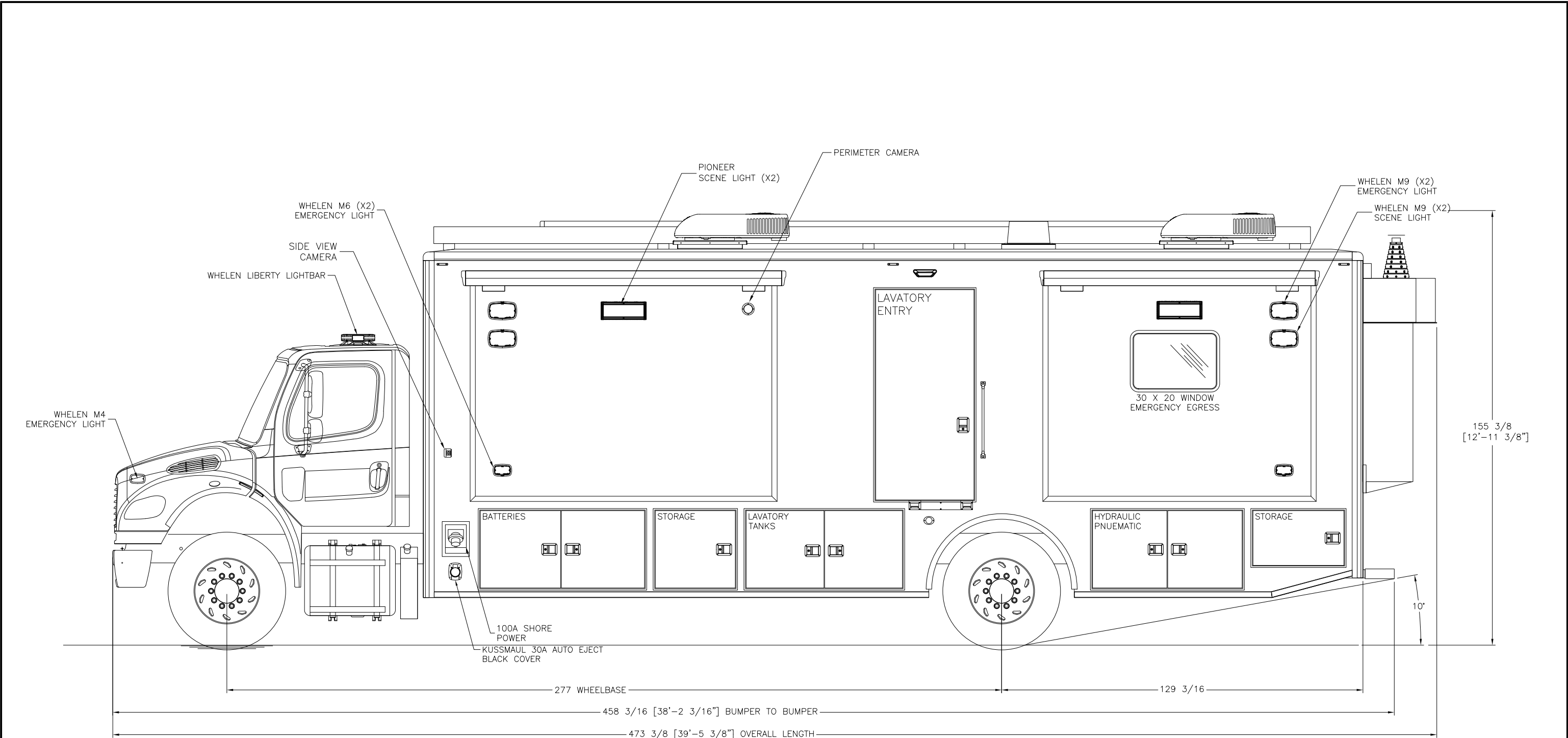

THIS DRAWING IS THE PROPERTY OF PIERCE MANUFACTURING. IT IS CONFIDENTIAL AND ALL RIGHTS ARE RESERVED. IT SHALL NOT BE REPRODUCED, COPIED, LENT, OR USED FOR ANY PURPOSE OTHER THAN THAT FOR WHICH IT IS SPECIFICALLY FURNISHED.

BID # 000  
REP: Steve Williamson - Frontline Communications  
DEALER: Halt Fire

PRELIMINARY USE ONLY  
THIS DRAWING IS FOR REPRESENTATION ONLY. DETAILED ENGINEERING DRAWINGS WILL BE CREATED FOR MANUFACTURING. CHANGES MAY BE REQUIRED TO ACCOMMODATE MANUFACTURING REQUIREMENTS AND CUSTOMER SPECIFICATIONS.

**FRONTLINE**  
**COMMUNICATIONS**  
An Oshkosh Corporation Company

DRAWN	JRP	DATE	01/28/25
SHEET	2 OF 6	NOT TO SCALE	

Eaton County Sheriff  
Mobile Command Unit  
C-37 X-2 - M2-106

SIZE	DWG NO.	REV
B	P2023-108	A

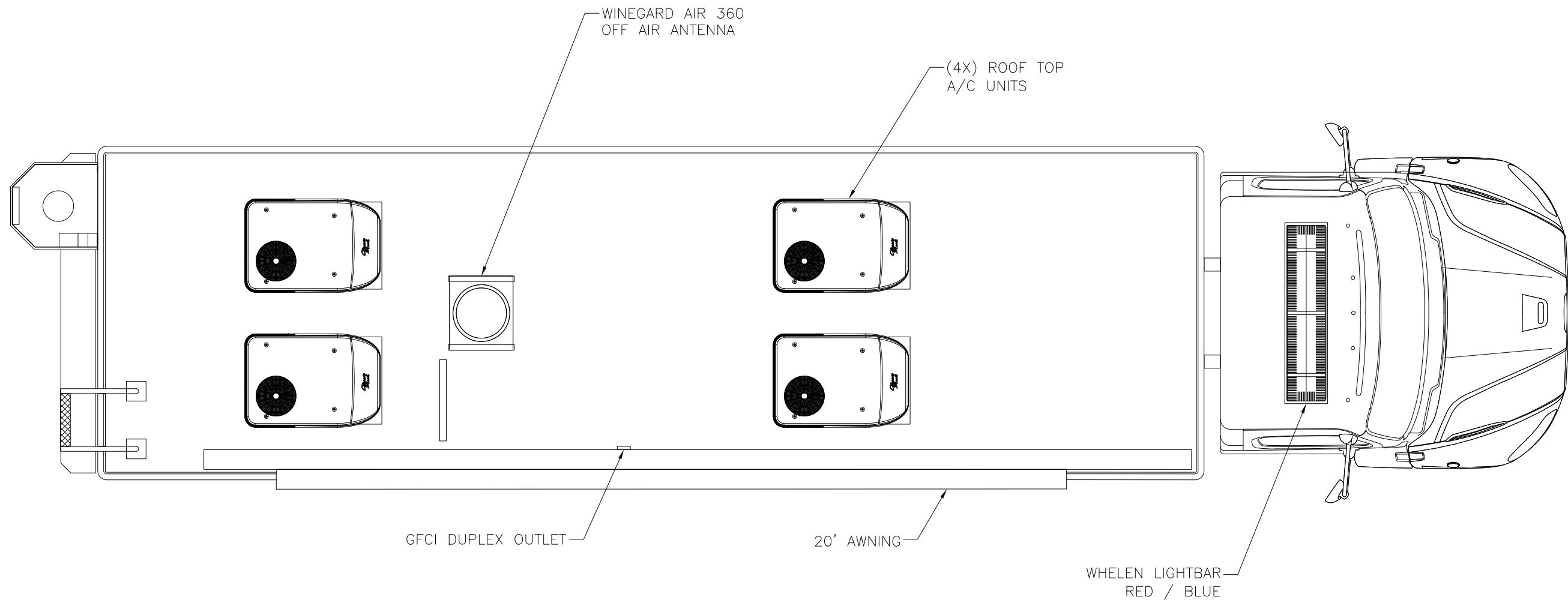

THIS DRAWING IS THE PROPERTY OF PIERCE  
MANUFACTURING. IT IS CONFIDENTIAL AND ALL RIGHTS ARE  
RESERVED. IT SHALL NOT BE REPRODUCED, COPIED, LENT,  
OR USED FOR ANY PURPOSE OTHER THAN THAT FOR WHICH  
IT IS SPECIFICALLY FURNISHED.

BID # 000  
REP: Steve Williamson - Frontline Communications  
DEALER: Halt Fire

PRELIMINARY USE ONLY  
THIS DRAWING IS FOR REPRESENTATION ONLY. DETAILED  
ENGINEERING DRAWINGS WILL BE CREATED FOR  
MANUFACTURING. CHANGES MAY BE REQUIRED TO  
ACCOMMODATE MANUFACTURING REQUIREMENTS AND  
CUSTOMER SPECIFICATIONS.

<b>FRONTLINE</b> COMMUNICATIONS An Oshkosh Corporation Company	Eaton County Sheriff Mobile Command Unit C-37 X-2 - M2-106		
	DRAWN JRP	DATE 01/28/25	SIZE B
SHEET 3 OF 6	NOT TO SCALE	DWG NO. P2023-108	REV A

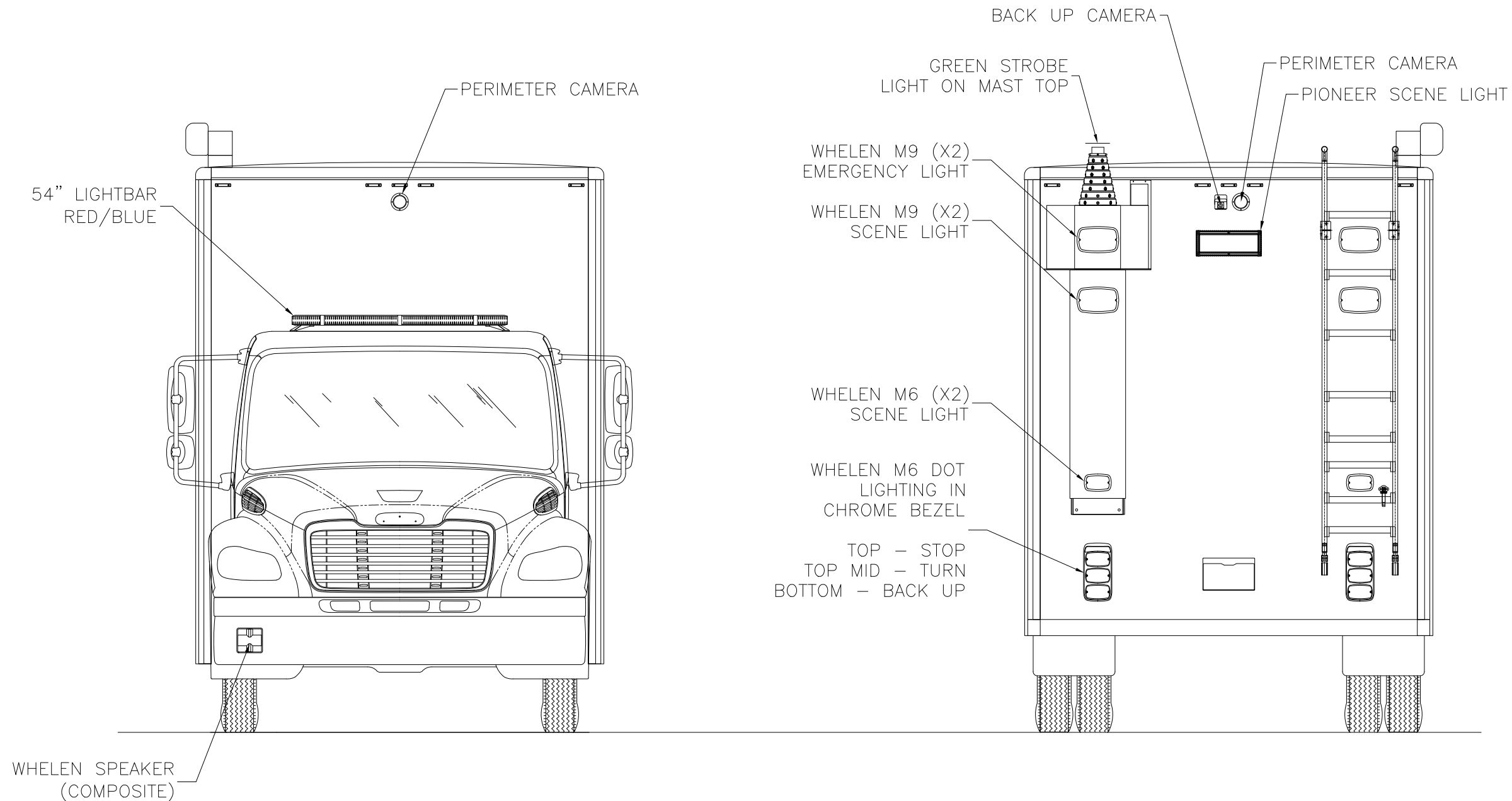

THIS DRAWING IS THE PROPERTY OF PIERCE  
MANUFACTURING. IT IS CONFIDENTIAL AND ALL RIGHTS ARE  
RESERVED. IT SHALL NOT BE REPRODUCED, COPIED, LENT,  
OR USED FOR ANY PURPOSE OTHER THAN THAT FOR WHICH  
IT IS SPECIFICALLY FURNISHED.

BID # 000

REP: Steve Williamson - Frontline Communications

DEALER: Halt Fire

PRELIMINARY USE ONLY

THIS DRAWING IS FOR REPRESENTATION ONLY. DETAILED  
ENGINEERING DRAWINGS WILL BE CREATED FOR  
MANUFACTURING. CHANGES MAY BE REQUIRED TO  
ACCOMMODATE MANUFACTURING REQUIREMENTS AND  
CUSTOMER SPECIFICATIONS.

**FRONTLINE**  
**COMMUNICATIONS**

An Oshkosh Corporation Company

DRAWN	JRP	DATE	01/28/25
SHEET	4 OF 6	NOT TO SCALE	

Eaton County Sheriff  
Mobile Command Unit  
C-37 X-2 - M2-106

SIZE	DWG NO.	REV
B	P2023-108	A

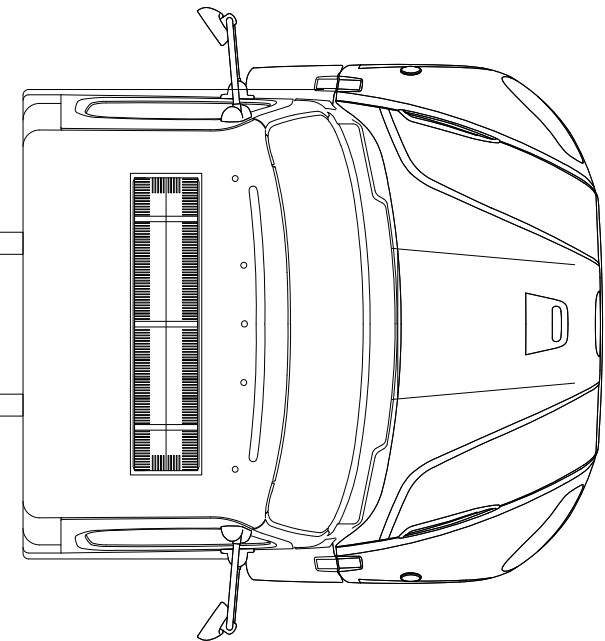
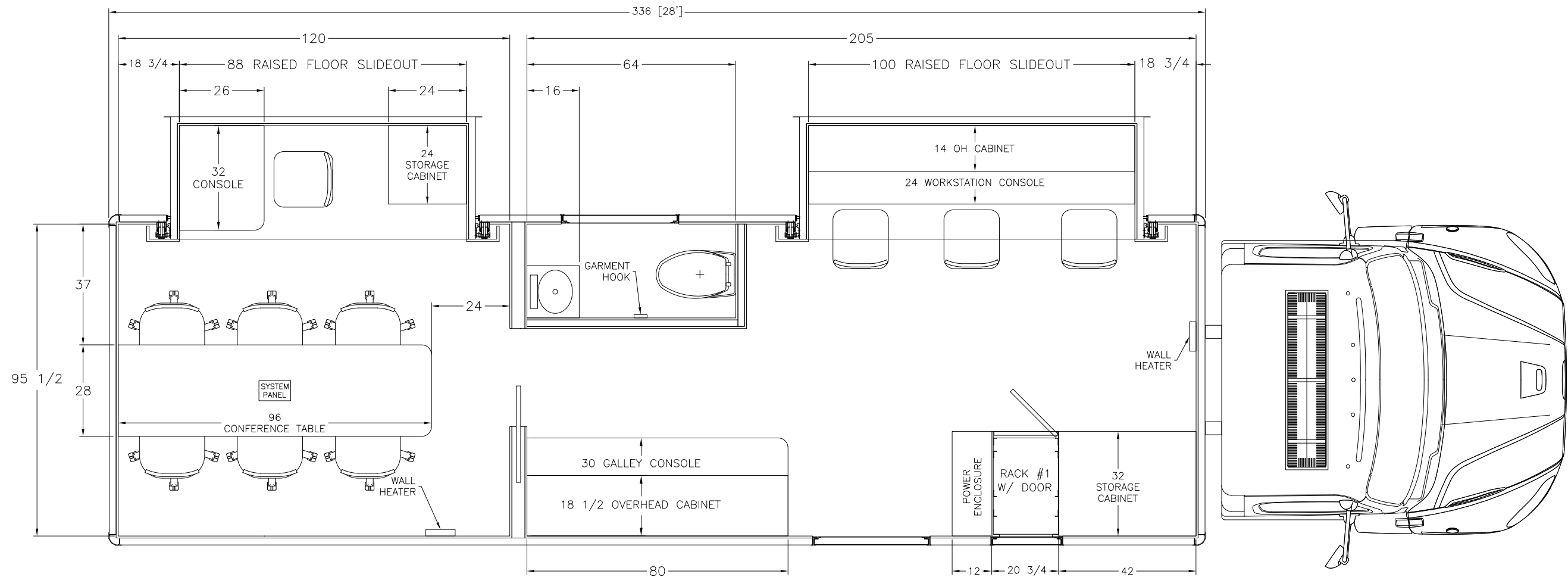

THIS DRAWING IS THE PROPERTY OF PIERCE MANUFACTURING. IT IS CONFIDENTIAL AND ALL RIGHTS ARE RESERVED. IT SHALL NOT BE REPRODUCED, COPIED, LENT, OR USED FOR ANY PURPOSE OTHER THAN THAT FOR WHICH IT IS SPECIFICALLY FURNISHED.

BID # 000  
 REP: Steve Williamson - Frontline Communications  
 DEALER: Halt Fire

PRELIMINARY USE ONLY  
 THIS DRAWING IS FOR REPRESENTATION ONLY. DETAILED ENGINEERING DRAWINGS WILL BE CREATED FOR MANUFACTURING. CHANGES MAY BE REQUIRED TO ACCOMMODATE MANUFACTURING REQUIREMENTS AND CUSTOMER SPECIFICATIONS.

**FRONTLINE**  
**COMMUNICATIONS**  
 An Oshkosh Corporation Company

DRAWN	JRP	DATE	01/28/25
SHEET	5 OF 6	NOT TO SCALE	

Eaton County Sheriff  
 Mobile Command Unit  
 C-37 X-2 - M2-106

SIZE	DWG NO.	REV
B	P2023-108	A

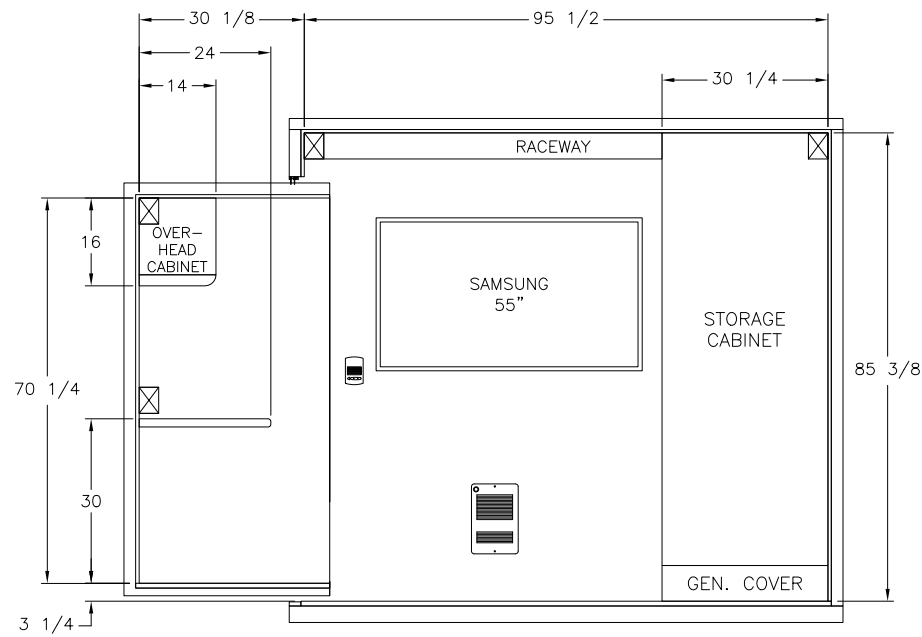

FRONT INTERIOR

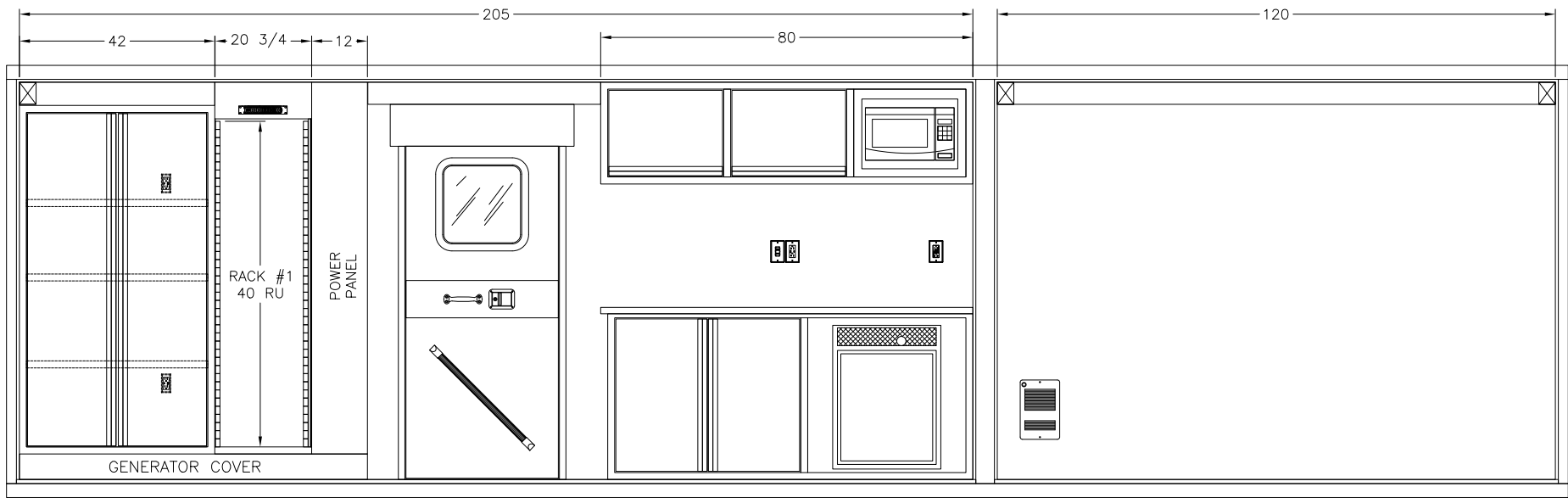

CURB INTERIOR

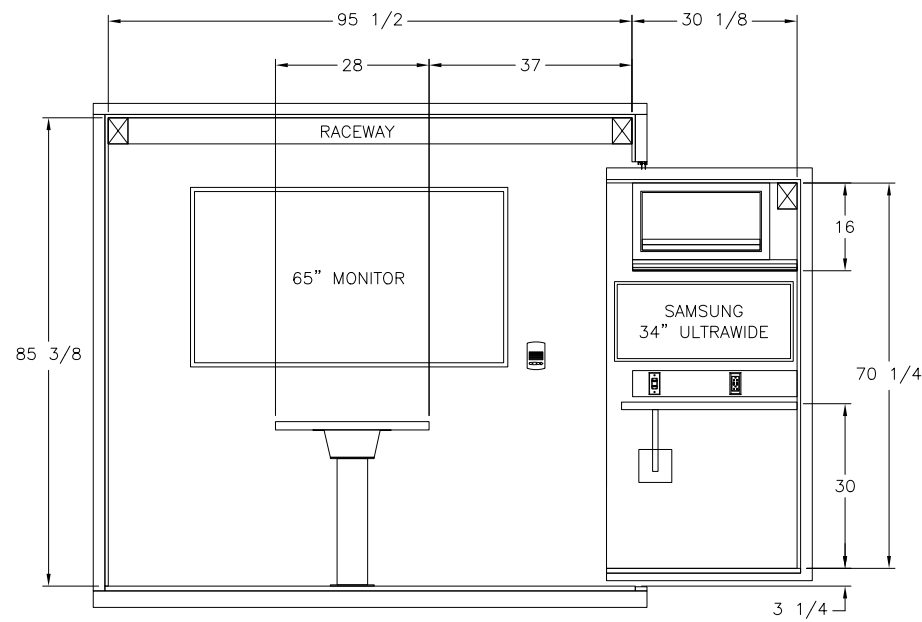

REAR INTERIOR

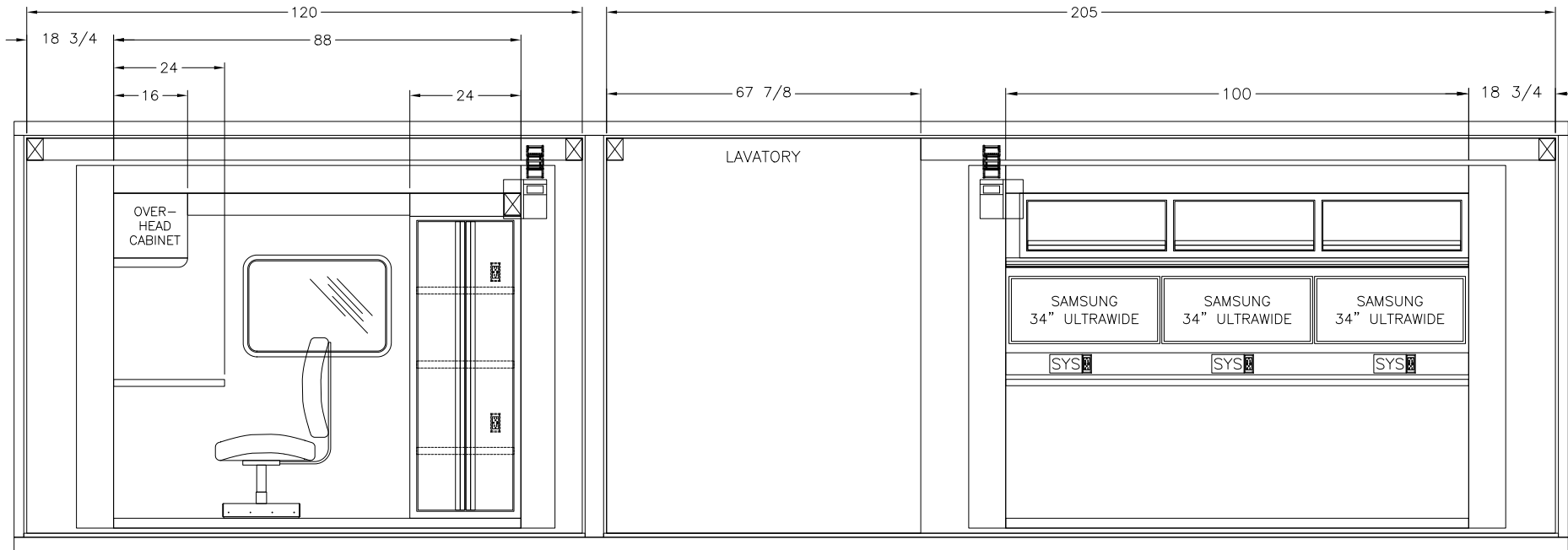

STREET INTERIOR

THIS DRAWING IS THE PROPERTY OF PIERCE MANUFACTURING. IT IS CONFIDENTIAL AND ALL RIGHTS ARE RESERVED. IT SHALL NOT BE REPRODUCED, COPIED, LENT, OR USED FOR ANY PURPOSE OTHER THAN THAT FOR WHICH IT IS SPECIFICALLY FURNISHED.

BID # 000  
 REP: Steve Williamson - Frontline Communications  
 DEALER: Halt Fire

PRELIMINARY USE ONLY  
 THIS DRAWING IS FOR REPRESENTATION ONLY. DETAILED ENGINEERING DRAWINGS WILL BE CREATED FOR MANUFACTURING. CHANGES MAY BE REQUIRED TO ACCOMMODATE MANUFACTURING REQUIREMENTS AND CUSTOMER SPECIFICATIONS.

**FRONTLINE**  
 COMMUNICATIONS  
 An Oshkosh Corporation Company

DRAWN JRP DATE 01/28/25  
 SHEET 6 OF 6 NOT TO SCALE

Eaton County Sheriff  
 Mobile Command Unit  
 C-37 X-2 - M2-106

SIZE B DWG NO. P2023-108 REV A