

THIS DRAWING IS THE PROPERTY OF PIERCE
MANUFACTURING. IT IS CONFIDENTIAL AND ALL RIGHTS ARE
RESERVED. IT SHALL NOT BE REPRODUCED, COPIED, LENT,
OR USED FOR ANY PURPOSE OTHER THAN THAT FOR WHICH
IT IS SPECIFICALLY FURNISHED.

PRELIMINARY USE ONLY
THIS DRAWING IS FOR REPRESENTATION ONLY. DETAILED
ENGINEERING DRAWINGS WILL BE CREATED FOR
MANUFACTURING. CHANGES MAY BE REQUIRED TO
ACCOMMODATE MANUFACTURING REQUIREMENTS AND
CUSTOMER SPECIFICATIONS.

DRAWN	MRS	DATE	8/26/24
SHEET	1 OF 6	NOT TO SCALE	

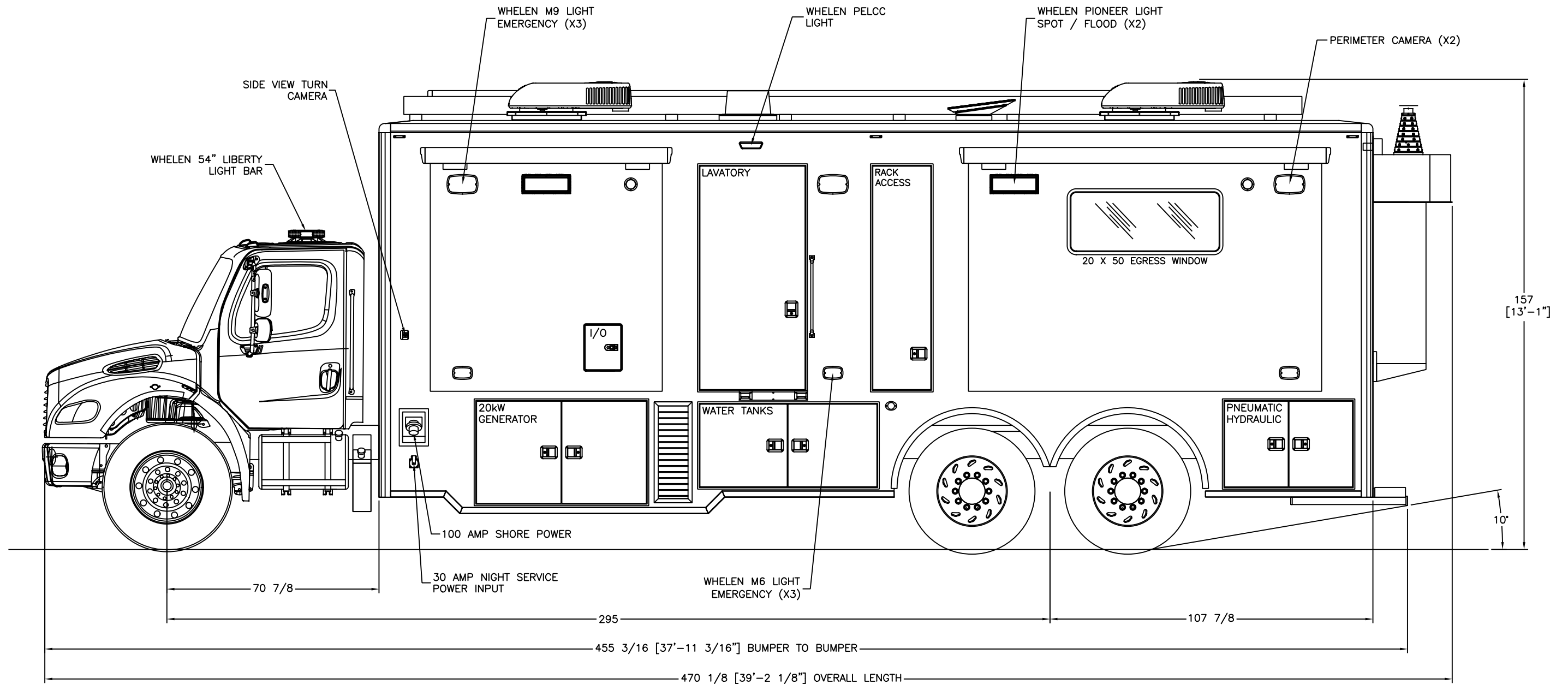

THIS DRAWING IS THE PROPERTY OF PIERCE MANUFACTURING. IT IS CONFIDENTIAL AND ALL RIGHTS ARE RESERVED. IT SHALL NOT BE REPRODUCED, COPIED, LENT, OR USED FOR ANY PURPOSE OTHER THAN THAT FOR WHICH IT IS SPECIFICALLY FURNISHED.

BID # 000
REP: Steve Williamson - Frontline Communications
DEALER: Halt Fire, Inc.

PRELIMINARY USE ONLY
THIS DRAWING IS FOR REPRESENTATION ONLY. DETAILED ENGINEERING DRAWINGS WILL BE CREATED FOR MANUFACTURING. CHANGES MAY BE REQUIRED TO ACCOMMODATE MANUFACTURING REQUIREMENTS AND CUSTOMER SPECIFICATIONS.

FRONTLINE
COMMUNICATIONS
An Oshkosh Corporation Company

DRAWN	MRS	DATE	8/26/24
SHEET	2 OF 6	NOT TO SCALE	

Monroe County (MI)
Mobile Command Unit
C-38 X-4 - M2-106

SIZE	DWG NO.	REV
B	P2024-95	A

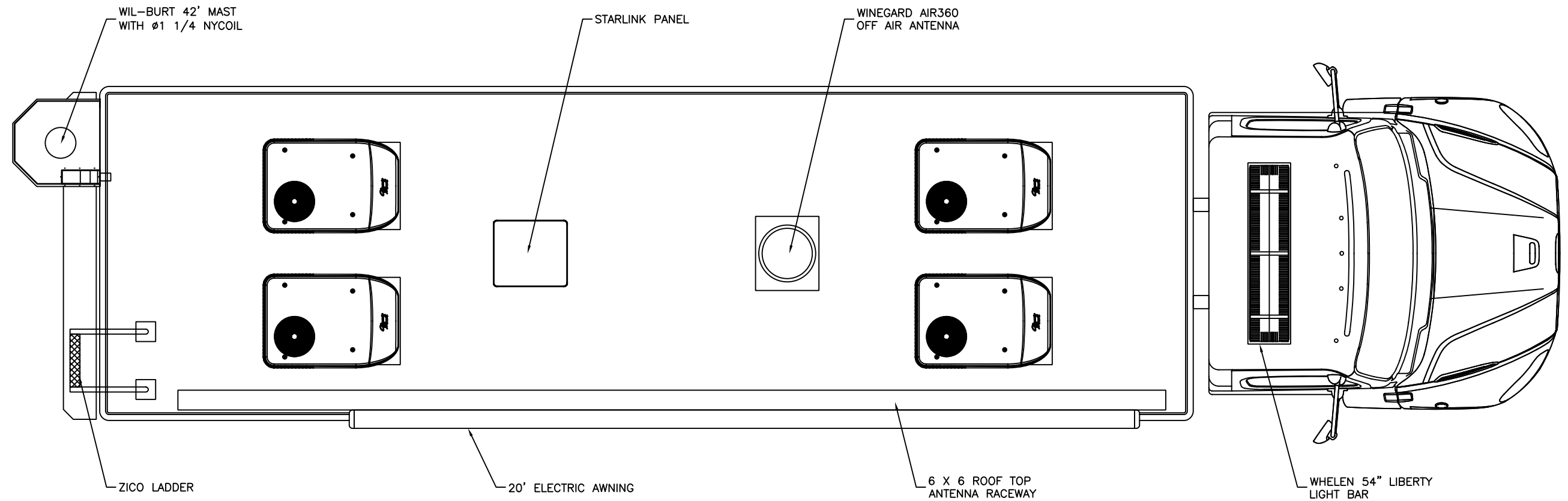

THIS DRAWING IS THE PROPERTY OF PIERCE
MANUFACTURING. IT IS CONFIDENTIAL AND ALL RIGHTS ARE
RESERVED. IT SHALL NOT BE REPRODUCED, COPIED, LENT,
OR USED FOR ANY PURPOSE OTHER THAN THAT FOR WHICH
IT IS SPECIFICALLY FURNISHED.

BID # 000
REP: Steve Williamson - Frontline Communications
DEALER: Halt Fire, Inc.

PRELIMINARY USE ONLY
THIS DRAWING IS FOR REPRESENTATION ONLY. DETAILED
ENGINEERING DRAWINGS WILL BE CREATED FOR
MANUFACTURING. CHANGES MAY BE REQUIRED TO
ACCOMMODATE MANUFACTURING REQUIREMENTS AND
CUSTOMER SPECIFICATIONS.

FRONTLINE
COMMUNICATIONS
An Oshkosh Corporation Company

DRAWN	MRS	DATE	8/26/24
SHEET	3 OF 6	NOT TO SCALE	

Monroe County (MI)
Mobile Command Unit
C-38 X-4 - M2-106

SIZE	DWG NO.	REV
B	P2024-95	A

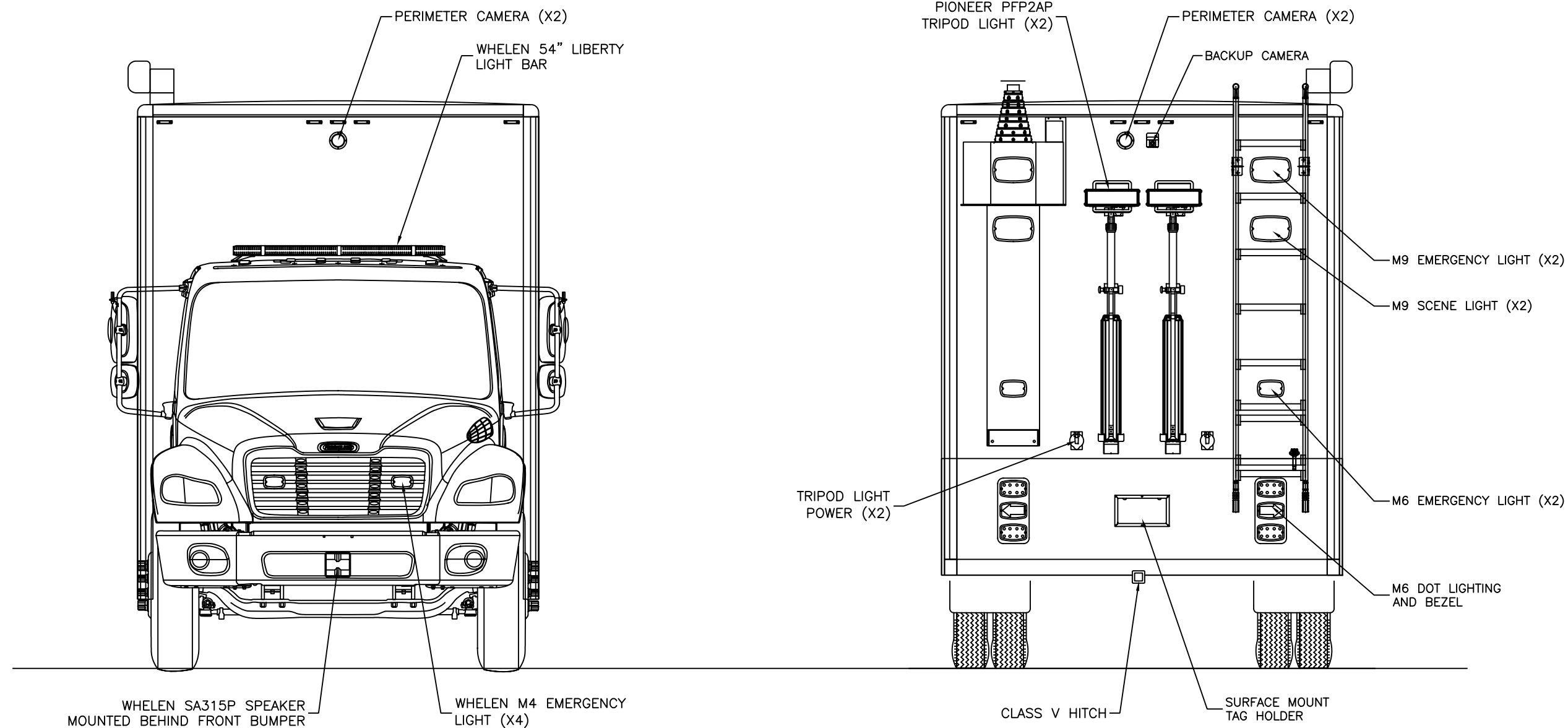

THIS DRAWING IS THE PROPERTY OF PIERCE MANUFACTURING. IT IS CONFIDENTIAL AND ALL RIGHTS ARE RESERVED. IT SHALL NOT BE REPRODUCED, COPIED, LENT, OR USED FOR ANY PURPOSE OTHER THAN THAT FOR WHICH IT IS SPECIFICALLY FURNISHED.

BID # 000
REP: Steve Williamson - Frontline Communications
DEALER: Halt Fire, Inc.

PRELIMINARY USE ONLY
THIS DRAWING IS FOR REPRESENTATION ONLY. DETAILED ENGINEERING DRAWINGS WILL BE CREATED FOR MANUFACTURING. CHANGES MAY BE REQUIRED TO ACCOMMODATE MANUFACTURING REQUIREMENTS AND CUSTOMER SPECIFICATIONS.

FRONTLINE
COMMUNICATIONS
An Oshkosh Corporation Company

DRAWN	MRS	DATE	8/26/24
SHEET	4 OF 6	NOT TO SCALE	

Monroe County (MI)
Mobile Command Unit
C-38 X-4 - M2-106

SIZE	DWG NO.	REV
B	P2024-95	A

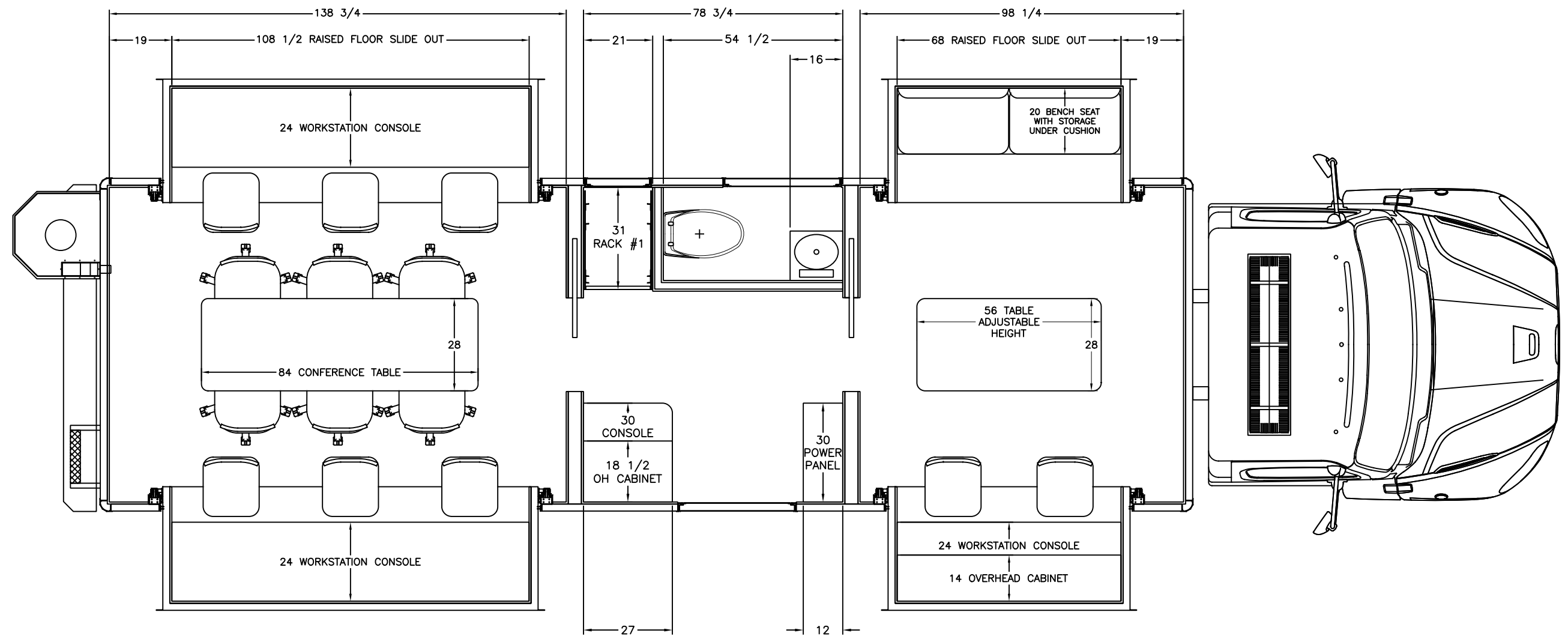

THIS DRAWING IS THE PROPERTY OF PIERCE MANUFACTURING. IT IS CONFIDENTIAL AND ALL RIGHTS ARE RESERVED. IT SHALL NOT BE REPRODUCED, COPIED, LENT, OR USED FOR ANY PURPOSE OTHER THAN THAT FOR WHICH IT IS SPECIFICALLY FURNISHED.

BID # 000
 REP: Steve Williamson - Frontline Communications
 DEALER: Halt Fire, Inc.

PRELIMINARY USE ONLY
 THIS DRAWING IS FOR REPRESENTATION ONLY. DETAILED ENGINEERING DRAWINGS WILL BE CREATED FOR MANUFACTURING. CHANGES MAY BE REQUIRED TO ACCOMMODATE MANUFACTURING REQUIREMENTS AND CUSTOMER SPECIFICATIONS.

FRONTLINE
 COMMUNICATIONS
 An Oshkosh Corporation Company

DRAWN	MRS	DATE	8/26/24
SHEET	5 OF 6	NOT TO SCALE	

Monroe County (MI)
 Mobile Command Unit
 C-38 X-4 - M2-106

SIZE	DWG NO.	REV
B	P2024-95	A

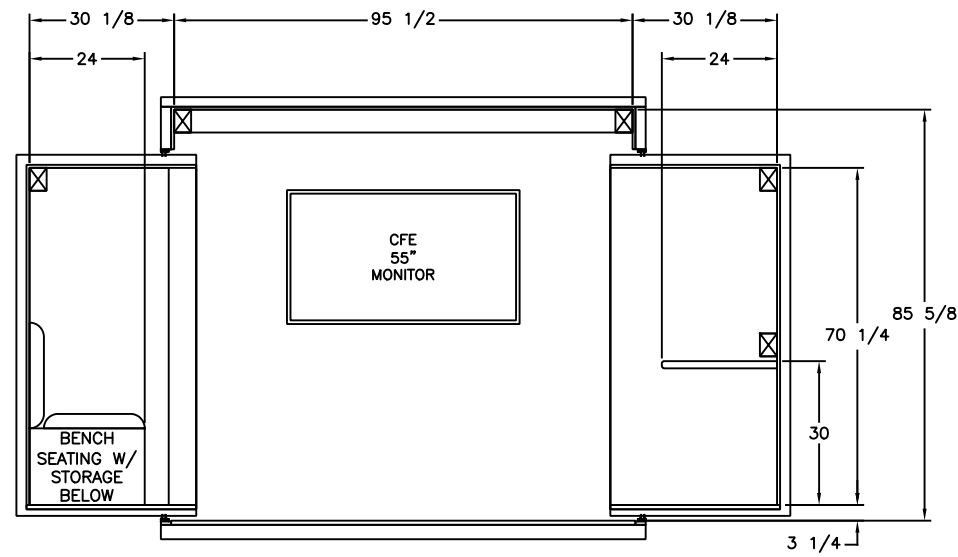

FRONT WALL INTERIOR LAYOUT

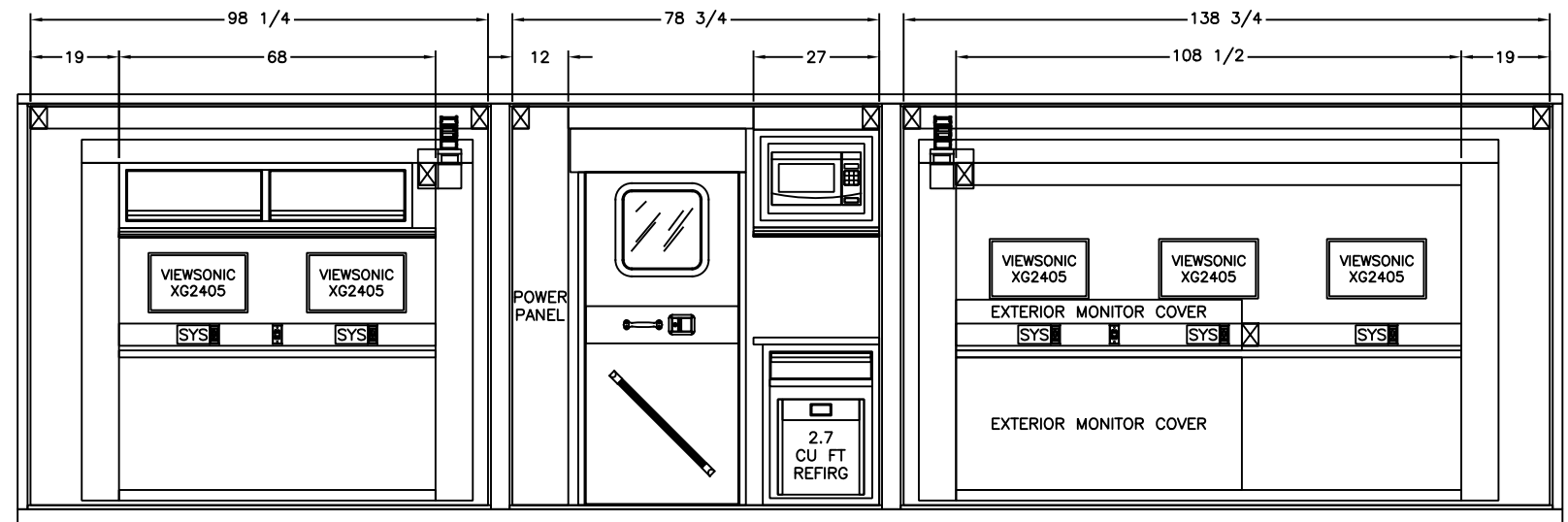

CURB SIDE INTERIOR LAYOUT

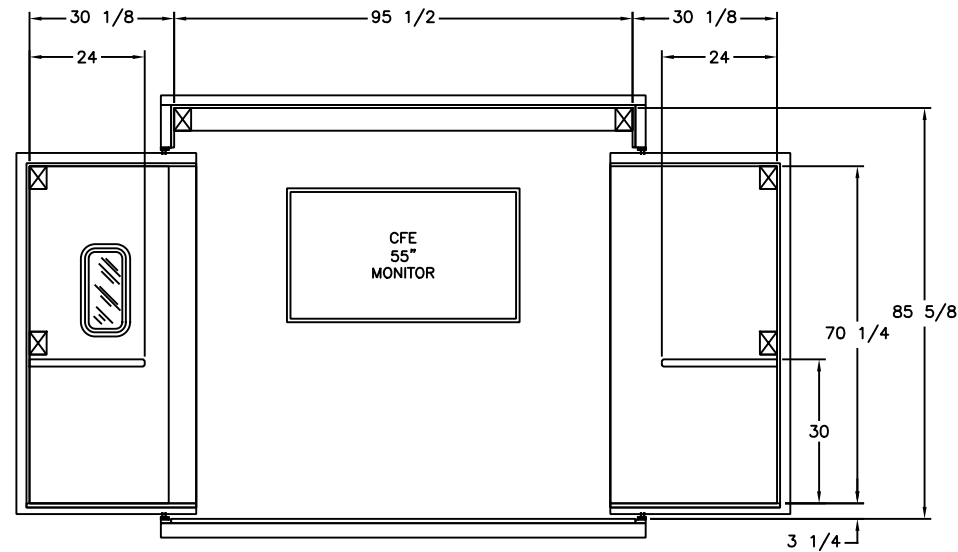

REAR WALL INTERIOR LAYOUT

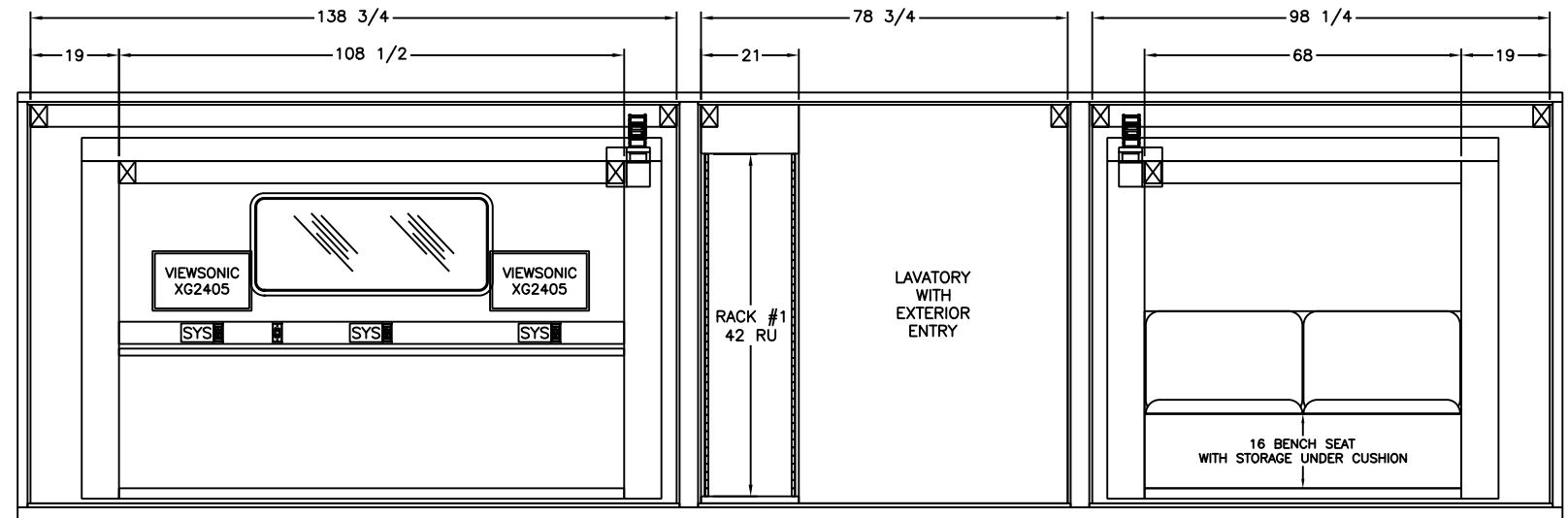

STREET SIDE INTERIOR LAYOUT

THIS DRAWING IS THE PROPERTY OF PIERCE MANUFACTURING. IT IS CONFIDENTIAL AND ALL RIGHTS ARE RESERVED. IT SHALL NOT BE REPRODUCED, COPIED, LENT, OR USED FOR ANY PURPOSE OTHER THAN THAT FOR WHICH IT IS SPECIFICALLY FURNISHED.

BID # 000
 REP: Steve Williamson - Frontline Communications
 DEALER: Halt Fire, Inc.

PRELIMINARY USE ONLY
 THIS DRAWING IS FOR REPRESENTATION ONLY. DETAILED ENGINEERING DRAWINGS WILL BE CREATED FOR MANUFACTURING. CHANGES MAY BE REQUIRED TO ACCOMMODATE MANUFACTURING REQUIREMENTS AND CUSTOMER SPECIFICATIONS.

FRONTLINE
 COMMUNICATIONS
 An Oshkosh Corporation Company

DRAWN MRS DATE 8/26/24
 SHEET 6 OF 6 NOT TO SCALE

Monroe County (MI)
 Mobile Command Unit
 C-38 X-4 - M2-106

SIZE B DWG NO. P2024-95 REV A