

THIS DRAWING IS THE PROPERTY OF PIERCE MANUFACTURING. IT IS CONFIDENTIAL AND ALL RIGHTS ARE RESERVED. IT SHALL NOT BE REPRODUCED, COPIED, LENT, OR USED FOR ANY PURPOSE OTHER THAN THAT FOR WHICH IT IS SPECIFICALLY FURNISHED.

BID # 92007 / 42018
REP: Andy Callaway - Frontline Communications
DEALER: Ten-8

PRELIMINARY USE ONLY
THIS DRAWING IS FOR REPRESENTATION ONLY. DETAILED ENGINEERING DRAWINGS WILL BE CREATED FOR MANUFACTURING. CHANGES MAY BE REQUIRED TO ACCOMMODATE MANUFACTURING REQUIREMENTS AND CUSTOMER SPECIFICATIONS.

FRONTLINE
COMMUNICATIONS
An Oshkosh Corporation Company

DRAWN	MRS	DATE	11/4/24
SHEET	1 OF 6	NOT TO SCALE	

Walton County Mobile Command Vehicle C-45 X-4 - Velocity		
SIZE	DWG NO.	REV
B	P2023-46	A

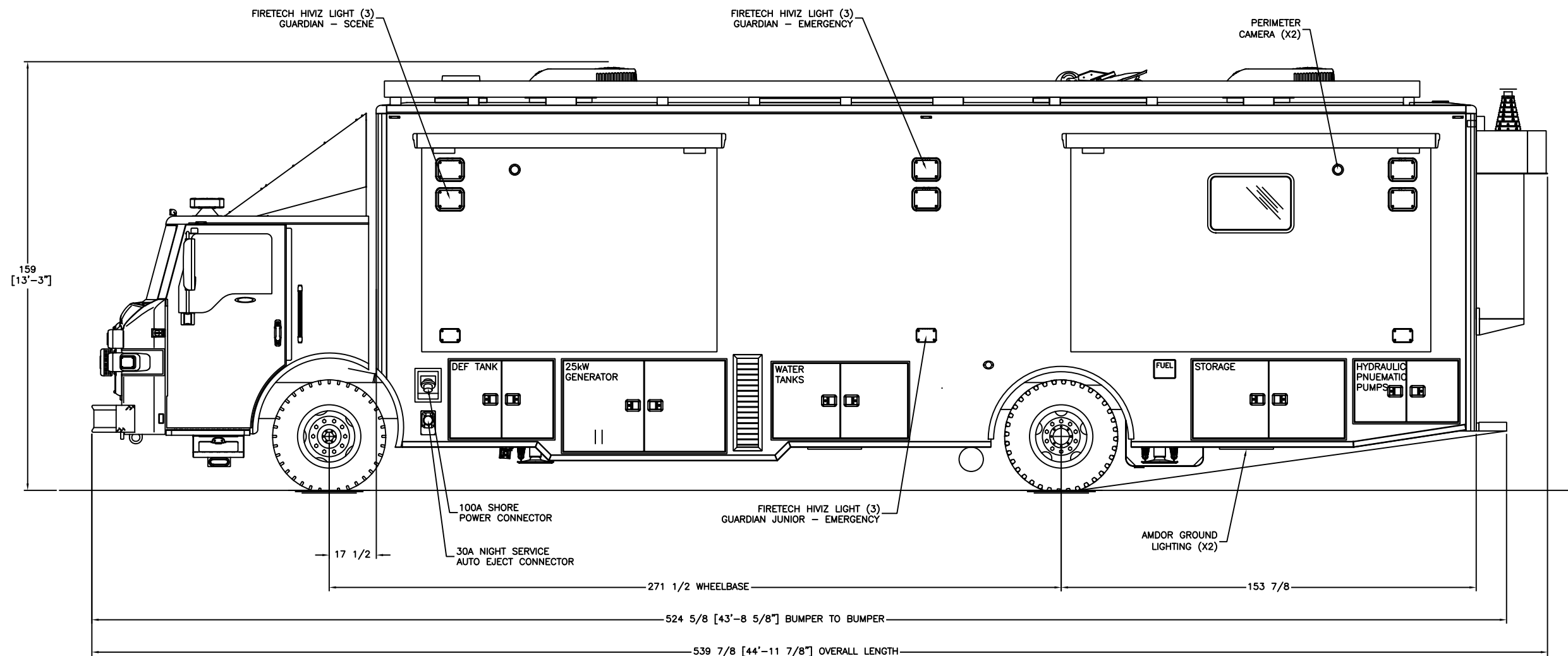

THIS DRAWING IS THE PROPERTY OF PIERCE MANUFACTURING. IT IS CONFIDENTIAL AND ALL RIGHTS ARE RESERVED. IT SHALL NOT BE REPRODUCED, COPIED, LENT, OR USED FOR ANY PURPOSE OTHER THAN THAT FOR WHICH IT IS SPECIFICALLY FURNISHED.

BID # 92007 / 42018
REP: Andy Callaway - Frontline Communications
DEALER: Ten-8

PRELIMINARY USE ONLY
THIS DRAWING IS FOR REPRESENTATION ONLY. DETAILED ENGINEERING DRAWINGS WILL BE CREATED FOR MANUFACTURING. CHANGES MAY BE REQUIRED TO ACCOMMODATE MANUFACTURING REQUIREMENTS AND CUSTOMER SPECIFICATIONS.

FRONTLINE
COMMUNICATIONS
An Oshkosh Corporation Company

DRAWN	MRS	DATE	11/4/24
SHEET	2 OF 6	NOT TO SCALE	

Walton County
Mobile Command Vehicle
C-45 X-4 - Velocity

SIZE	DWG NO.	REV
B	P2023-46	A

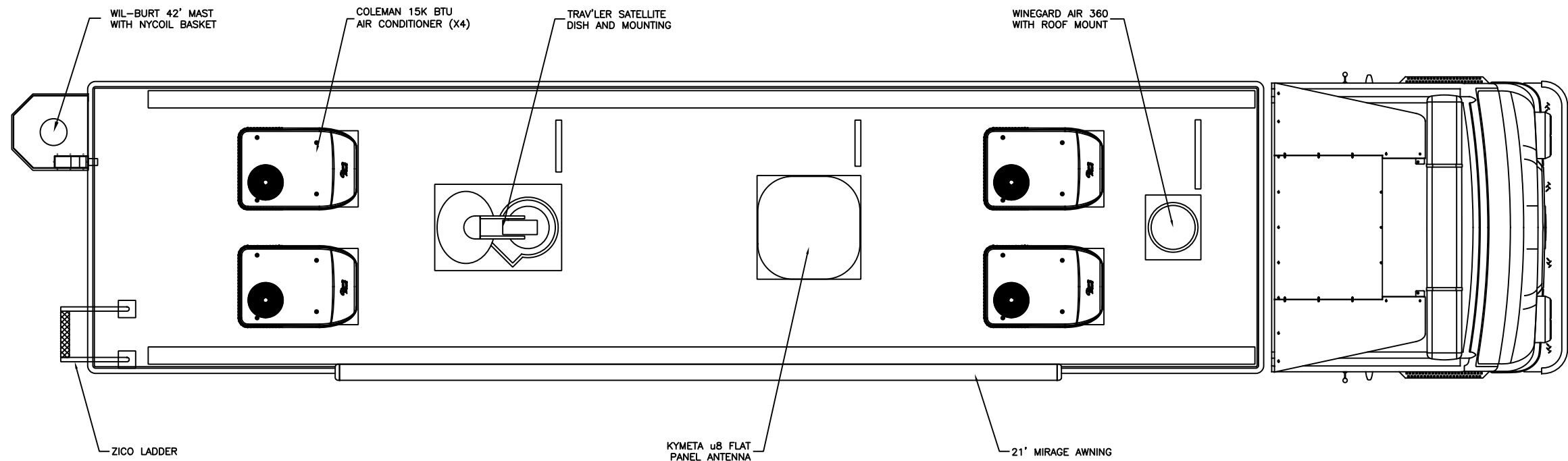

THIS DRAWING IS THE PROPERTY OF PIERCE MANUFACTURING. IT IS CONFIDENTIAL AND ALL RIGHTS ARE RESERVED. IT SHALL NOT BE REPRODUCED, COPIED, LENT, OR USED FOR ANY PURPOSE OTHER THAN THAT FOR WHICH IT IS SPECIFICALLY FURNISHED.

BID # 92007 / 42018
REP: Andy Callaway - Frontline Communications
DEALER: Ten-8

PRELIMINARY USE ONLY
THIS DRAWING IS FOR REPRESENTATION ONLY. DETAILED ENGINEERING DRAWINGS WILL BE CREATED FOR MANUFACTURING. CHANGES MAY BE REQUIRED TO ACCOMMODATE MANUFACTURING REQUIREMENTS AND CUSTOMER SPECIFICATIONS.

FRONTLINE
COMMUNICATIONS
An Oshkosh Corporation Company

DRAWN	MRS	DATE	11/4/24
SHEET	3 OF 6	NOT TO SCALE	

Walton County Mobile Command Vehicle C-45 X-4 - Velocity		
SIZE	DWG NO.	REV
B	P2023-46	A

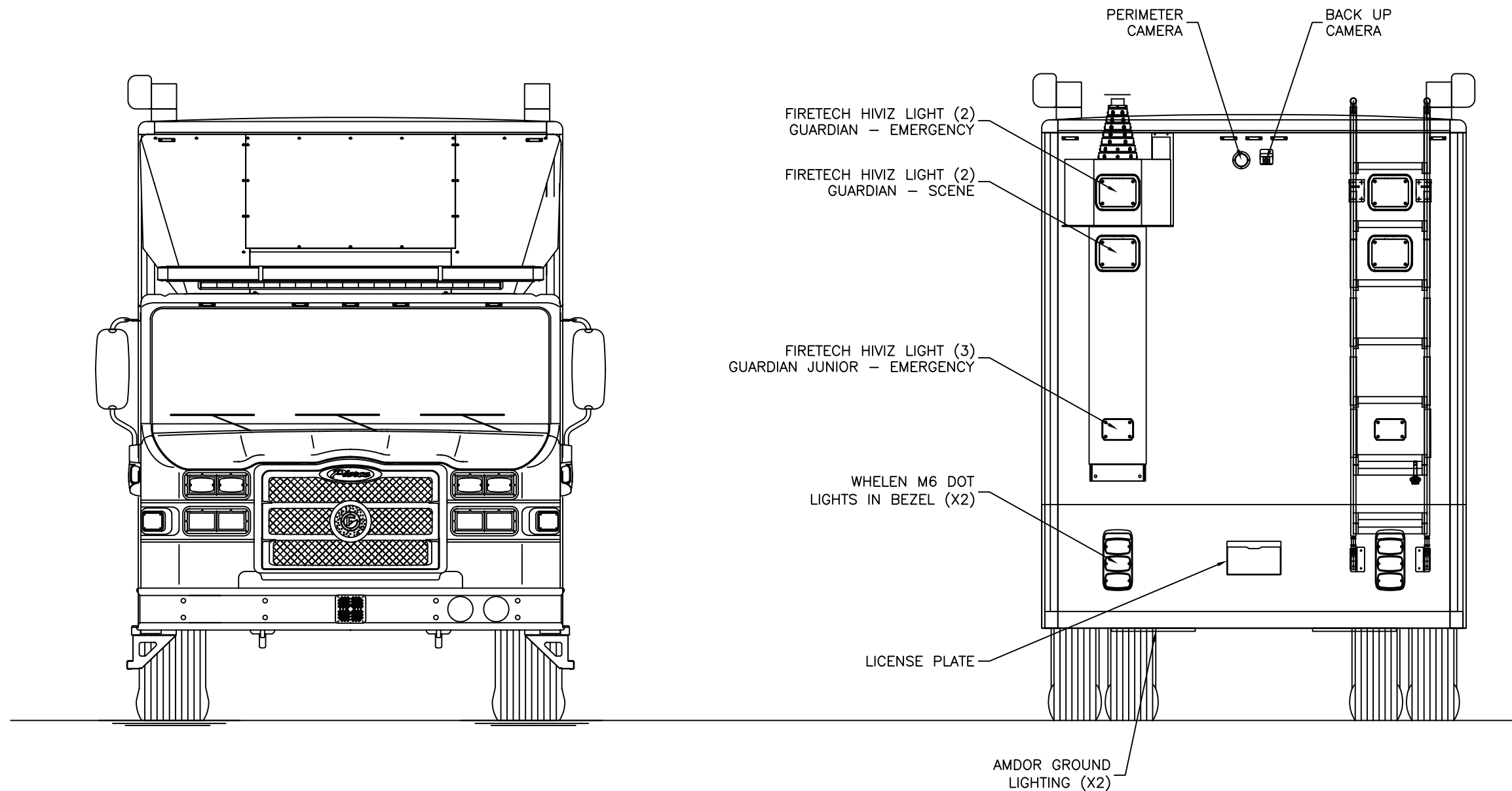

THIS DRAWING IS THE PROPERTY OF PIERCE
MANUFACTURING. IT IS CONFIDENTIAL AND ALL RIGHTS ARE
RESERVED. IT SHALL NOT BE REPRODUCED, COPIED, LENT,
OR USED FOR ANY PURPOSE OTHER THAN THAT FOR WHICH
IT IS SPECIFICALLY FURNISHED.

BID # 92007 / 42018

REP: Andy Callaway - Frontline Communications

DEALER: Ten-8

PRELIMINARY USE ONLY

THIS DRAWING IS FOR REPRESENTATION ONLY. DETAILED
ENGINEERING DRAWINGS WILL BE CREATED FOR
MANUFACTURING. CHANGES MAY BE REQUIRED TO
ACCOMMODATE MANUFACTURING REQUIREMENTS AND
CUSTOMER SPECIFICATIONS.

FRONTLINE
COMMUNICATIONS

An Oshkosh Corporation Company

DRAWN

MRS

DATE

11/4/24

SHEET

4 OF 6

NOT TO SCALE

SIZE

B

DWG NO.

P2023-46

REV

A

Walton County
Mobile Command Vehicle
C-45 X-4 - Velocity

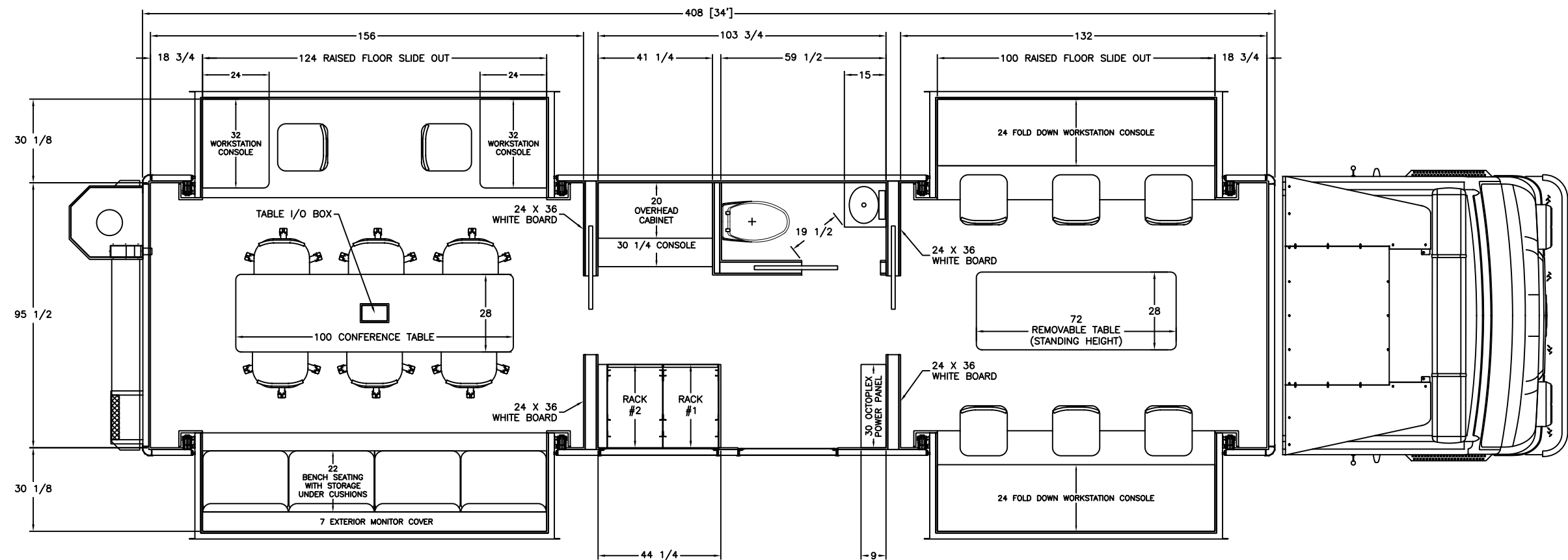

THIS DRAWING IS THE PROPERTY OF PIERCE MANUFACTURING. IT IS CONFIDENTIAL AND ALL RIGHTS ARE RESERVED. IT SHALL NOT BE REPRODUCED, COPIED, LENT, OR USED FOR ANY PURPOSE OTHER THAN THAT FOR WHICH IT IS SPECIFICALLY FURNISHED.

BID # 92007 / 42018
 REP: Andy Callaway - Frontline Communications
 DEALER: Ten-8

PRELIMINARY USE ONLY
 THIS DRAWING IS FOR REPRESENTATION ONLY. DETAILED ENGINEERING DRAWINGS WILL BE CREATED FOR MANUFACTURING. CHANGES MAY BE REQUIRED TO ACCOMMODATE MANUFACTURING REQUIREMENTS AND CUSTOMER SPECIFICATIONS.

FRONTLINE
 COMMUNICATIONS
 An Oshkosh Corporation Company

DRAWN	MRS	DATE	11/4/24
SHEET	5 OF 6	NOT TO SCALE	

Walton County
 Mobile Command Vehicle
 C-45 X-4 - Velocity

SIZE	DWG NO.	REV
B	P2023-46	A

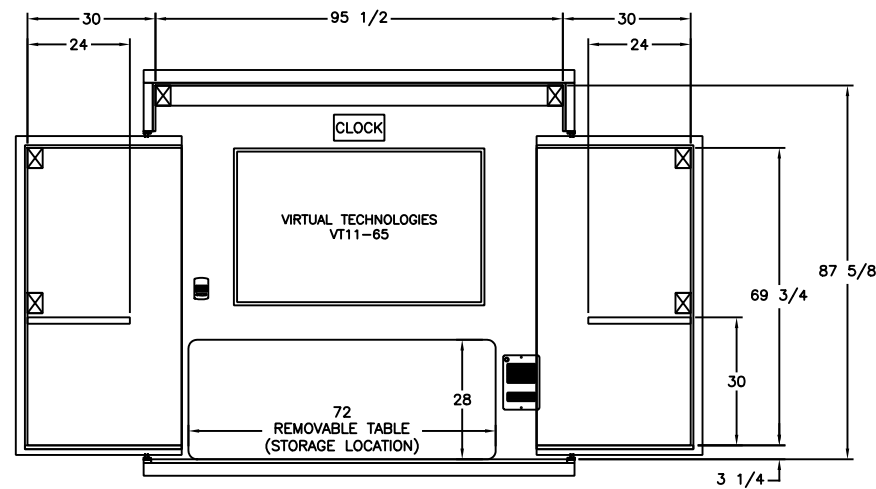

FRONT INTERIOR WALL LAYOUT

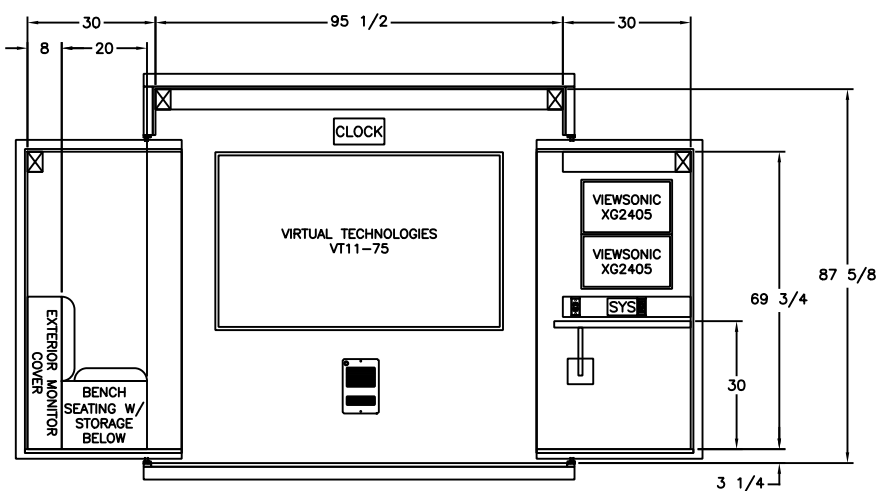
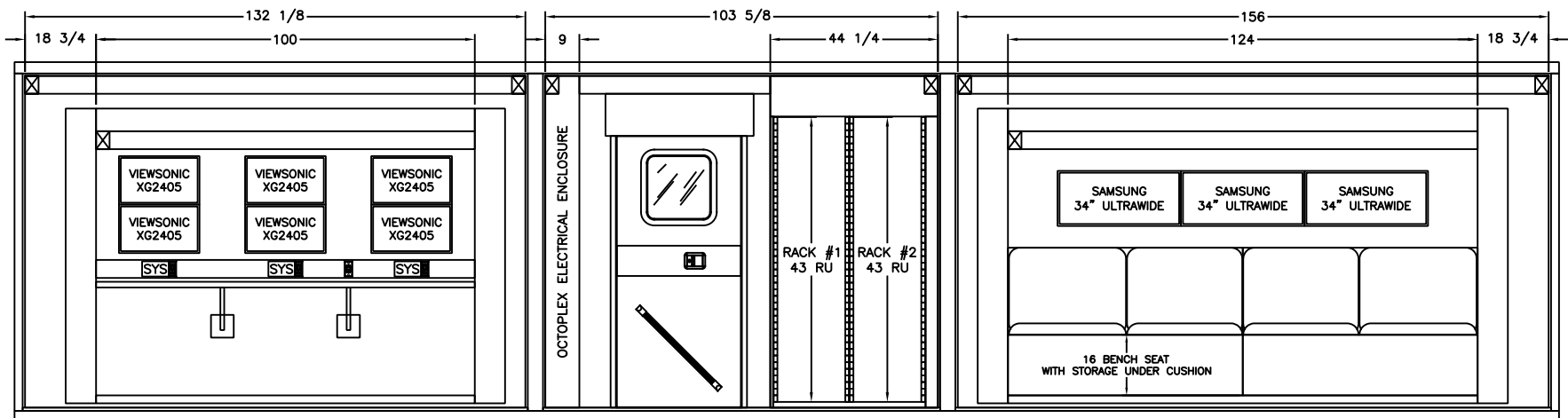

REAR INTERIOR WALL LAYOUT

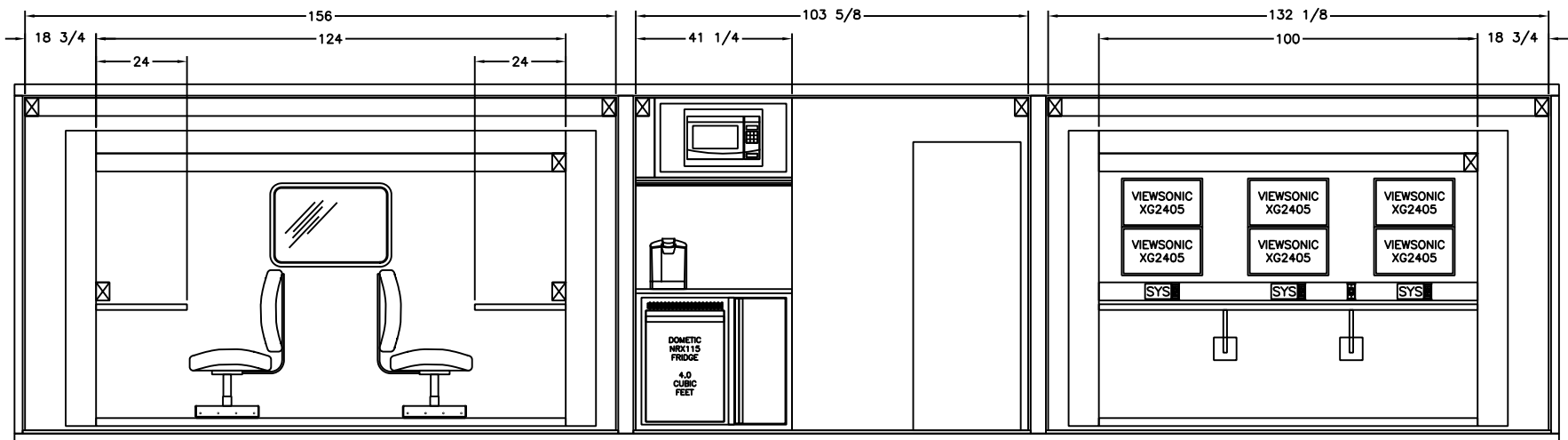

THIS DRAWING IS THE PROPERTY OF PIERCE MANUFACTURING. IT IS CONFIDENTIAL AND ALL RIGHTS ARE RESERVED. IT SHALL NOT BE REPRODUCED, COPIED, LENT, OR USED FOR ANY PURPOSE OTHER THAN THAT FOR WHICH IT IS SPECIFICALLY FURNISHED.

BID # 92007 / 42018
 REP: Andy Callaway - Frontline Communications
 DEALER: Ten-8

PRELIMINARY USE ONLY
 THIS DRAWING IS FOR REPRESENTATION ONLY. DETAILED ENGINEERING DRAWINGS WILL BE CREATED FOR MANUFACTURING. CHANGES MAY BE REQUIRED TO ACCOMMODATE MANUFACTURING REQUIREMENTS AND CUSTOMER SPECIFICATIONS.

FRONTLINE
 COMMUNICATIONS
 An Oshkosh Corporation Company

DRAWN MRS DATE 11/4/24
 SHEET 6 OF 6 NOT TO SCALE

Walton County
 Mobile Command Vehicle
 C-45 X-4 - Velocity

SIZE DWG NO. REV
 B P2023-46 A